

SBV SERIES

Ball Valve

The ball valve of series SBV is applicable for commercial air conditioner, freezing or deep-freezing equipment or other refrigeration circuits in order to open and to shut off inner flow path by operating the valve stem. It can also be used as service valve for vacuum pumping and refrigerant injection etc.

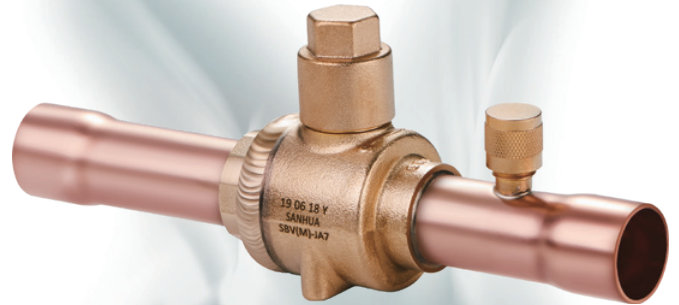

FEATURES

- STRAIGHTWAY TYPE, FULL PORT, LOW PRESSURE DROP , COST-EFFECTIVE
- VALVE BODY AND VALVE SEAT WITH WELDED STRUCTURE, WITH HIGH PRODUCT RELIABILITY
- BIDIRECTIONAL FLOW
- ROTATION STOP RING IS BUILT IN FROM SIZE OF 1-1/8" FOR FULL-OPEN AND FULL-CLOSE OF THE VALVE
- SPECIAL SEALING MATERIALS TO PREVENT INTERNAL LEAKAGE

GENERAL SPECIFICATIONS

- Applicable for all common HCFC, HFC, HFO refrigerants such as R22, R134a, R404A, R407A/F, R407C, R410A, R448A, R449A, R450A, R452A, R513A, R507
- Medium temperature TS min./max.: -40°C / +120°C (120°C - 150°C for short term use)
- Max. operating pressure PS: 4,5 MPa (45 bar)
- Installation position: liquid, hot gas, suction and discharge line in all directions
- Certifications: UL/CUL and PED declaration

SBV SERIES

Ball Valve

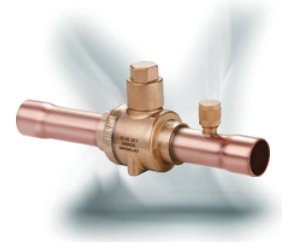

GENERAL CHARACTERISTICS

SBV standard model (Full PORT)

Series	Connections		Kv	Without Access Fitting	With Access Fitting
	[inch]	[mm]	[m ³ /h]	Model	Model
SBV 6	-	6	1.9	SBV02-020	SBV02-320
SBV 6	1/4	-	1.9	SBV02-019	SBV02-319
SBV 10	3/8	-	5.5	SBV03-019	SBV03-319
SBV 10	-	10	5.5	SBV03-020	SBV03-320
SBV 12	-	12	7.3	SBV04-020	SBV04-320
SBV 12	1/2	-	7.3	SBV04-019	SBV04-319
SBV 15	-	15	13.8	SBV(M)-A5YHSY-2-SA	SBV(M)-JA5YHSY-2-SA
SBV 16	5/8	16	13.8	SBV(M)-A5YHSY-1-SA	SBV(M)-JA5YHSY-1-SA
SBV 18	-	18	20.6	SBV(M)-A6YHSY-2-SA	SBV(M)-JA6YHSY-2-SA
SBV 18	3/4	19	20.6	SBV(M)-A6YHSY-1-SA	SBV(M)-JA6YHSY-1-SA
SBV 22	7/8	22	29	SBV(M)-A7YHSY-1-SA	SBV(M)-JA7YHSY-1-SA
SBV 28	-	28	54.3	SBV(M)-A9YHSY-2-SA	SBV(M)-JA9YHSY-2-SA
SBV 28	1-1/8	-	54.3	SBV(M)-A9YHSY-1-SA	SBV(M)-JA9YHSY-1-SA
SBV 35	1-3/8	35	85.5	SBV(M)-A11YHSY-1-SA	SBV(M)-JA11YHSY-1-SA
SBV 42	1-5/8	-	133.7	SBV(M)-A13YHSY-2-SA	SBV(M)-JA13YHSY-2-SA
SBV 42	-	42	133.7	SBV(M)-A13YHSY-1-SA	SBV(M)-JA13YHSY-1-SA
SBV 54	2-1/8	54	225	SBV(M)-A17YHSY-1-SA	SBV(M)-JA17YHSY-1-SA
SBV 64	-	64	225	SBV(M)-A19YHSY-1-SA	SBV(M)-JA19YHSY-1-SA
SBV 67	2-5/8	-	380	SBV(M)-A21YHSY-2-SA	SBV(M)-JA21YHSY-2-SA
SBV 79	3-1/8	79	530	SBV(M)-A25YHSY-2-SA	SBV(M)-JA25YHSY-2-SA
SBV 92	3-5/8	92	700	SBV(M)-A29YHSY-1-SA	SBV(M)-JA29YHSY-1-SA
SBV 105	4-1/8	105	950	SBV(M)-A33YHSY-2-SA	SBV(M)-JA33YHSY-2-SA
SBV 108	4-1/4	108	950	SBV(M)-A34YHSY-1-SA	SBV(M)-JA34YHSY-1-SA

SBV SERIES

Ball Valve

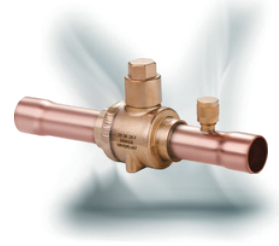

DIMENSIONS & WEIGHT

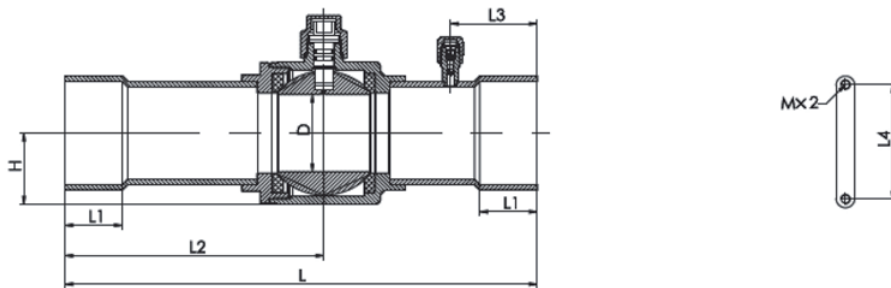

Series	Connections Ø d ODF		L [mm]	L1 [mm]	L2 [mm]	L3 [mm]	L4 [mm]	D [mm]	H [mm]	M [mm]	Weight [kg]
	[Inch]	[mm]									
SBV 6	1/4	6	132	10	68	31	16	10	14	M4 x 0.7	0.20
SBV 10	3/8	10	132	10	68	31	16	10	14	M4 x 0.7	0.20
SBV 12	1/2	12	160	10	85	42.5	16	10	14	M4 x 0.7	0.21
SBV 15	-	15	160	13	85	31	22	14	16	M4 x 0.7	0.30
SBV 16	5/8	16	160	13	85	31	22	14	16	M4 x 0.7	0.30
SBV 18	3/4	18/19	185	16	99	37	30	19	20	M4 x 0.7	0.51
SBV 22	7/8	22	185	17	99	37	30	19	20	M4 x 0.7	0.52
SBV 28	1-1/8	28	208	21	112	44	38	25	25	M4 x 0.7	0.73
SBV 35	1-3/8	35	251	25	136	44	48	32	31	M6 x 1.0	1.42
SBV 42	1-5/8	42	281	28	151	56	55	38	35	M6 x 1.0	1.90
SBV 54	2-1/8	54	305	34	167	56	74	50	46	M6 x 1.0	3.74
SBV 64	-	64	305	34	167	70	74	50	46	M6 x 1.0	3.79
SBV 67	2-5/8	-	305	37	167	56	74	60	56	M6 x 1.0	6.08
SBV 79	3-1/8	79	378	42	186	80	90	70	63	M6 x 1.0	8.81
SBV 92	3-5/8	92	423	42	208	75	108	80	75	M6 x 1.0	11.47
SBV 105	4-1/8	105	423	42	210	75	148	95	91	M6 x 1.0	20.17
SBV 108	4-1/4	108	423	42	210	75	148	95	91	M6 x 1.0	20.17

SBV SERIES

Ball Valve

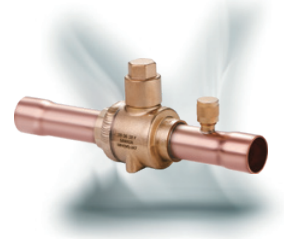

SBV standard model (Necking)

Connections Ø d ODF		Kv [m ³ /h]	Model	
[inch]	[mm]		Without Access Fitting	With Access Fitting
5/8	16	7.3	SBV05-601	SBV05-801
-	18	13.8	SBV06-602	SBV06-802
3/4	-	13.8	SBV06-601	SBV06-801
7/8	22	13.8	SBV07-601	SBV07-801
-	28	29	SBV09-602	SBV09-802
1-1/8	-	29	SBV09-601	SBV09-801
1-3/8	35	54.3	SBV11-601	SBV11-801
1-5/8	-	85.5	SBV13-601	SBV13-801
-	42	85.5	SBV13-602	SBV13-802
2-1/8	54	133.7	SBV17-601	SBV17-801
2-5/8	-	225	SBV21-601	-
3-1/8	80	380	SBV25-601	-
3-5/8	92	530	SBV29-601	-
4-1/8	105	700	SBV33-601	-
4-1/4	108	700	SBV34-601	-

DIMENSIONS

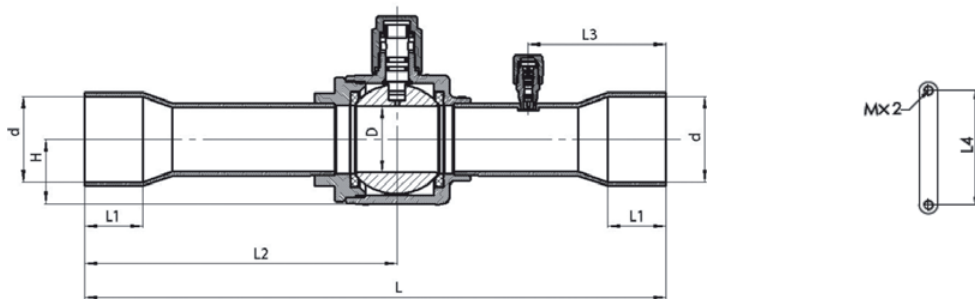

Model		L	L1	L2	L3	L4	D	H	M	Weight
Without Access Fitting	With Access Fitting	[mm]	[mm]	[mm]	[mm]	[mm]	[mm]	[mm]	[mm]	[kg]
SBV05-601	SBV05-801	161	13	84	36	16	10	14	M4 x 0.7	0.22
SBV06-602	SBV06-802	185	16	99	46	22	14	16	M4 x 0.7	0.33
SBV06-601	SBV06-801	185	16	99	46	22	14	16	M4 x 0.7	0.33
SBV07-601	SBV07-801	185	17	99	46	22	14	16	M4 x 0.7	0.34
SBV09-602	SBV09-802	208	21	112	53	30	19	20	M4 x 0.7	0.56
SBV09-601	SBV09-801	208	21	112	53	30	19	20	M4 x 0.7	0.56
SBV11-601	SBV11-801	251	25	136	63	38	25	25	M4 x 0.7	0.81
SBV13-601	SBV13-801	281	28	151	66.5	48	32	31	M6 x 1.0	1.51
SBV13-602	SBV13-802	281	28	151	66.5	48	32	31	M6 x 1.0	1.51
SBV17-601	SBV17-801	305	34	167	63	55	38	35	M6 x 1.0	2.31
SBV21-601	-	305	37	135	-	74	50	46	M6 x 1.0	3.80
SBV25-601	-	378	42	186	-	74	60	56	M6 x 1.0	6.58
SBV29-601	-	423	42	208	-	90	70	63	M6 x 1.0	9.35
SBV33-601	-	423	42	210	-	108	80	75	M6 x 1.0	11.71
SBV34-601	-	423	42	210	-	108	80	75	M6 x 1.0	11.76