

TCJ SERIES

Charge Valve

Charge valves are mainly installed in air conditioning and refrigeration systems. They are used as service valve for circuit evacuation to vacuum and for refrigerant injection.

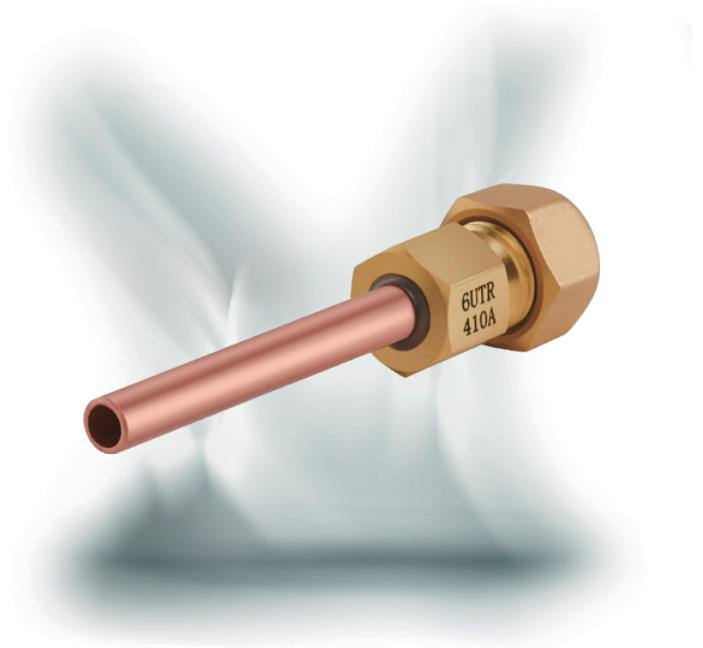

FEATURES

- SIMPLE STRUCTURE, CONVENIENT TO USE
- PREVENT REFRIGERANT LOSS THROUGH INTEGRATED SHRAEDER VALVE

GENERAL SPECIFICATION

- Applicable for all common HCFC and HFC refrigerants such as: R22, R134a, R404A, R407C, R410A, R32
- Ambient temperature min./max.: -20/+60°C
- Medium temperature TS min./max.: -30°C / +120°C
- Max. operating pressure PS: 4,3 MPa (43 bar)
- Installation position: liquid or Suction Line

DIMENSIONS

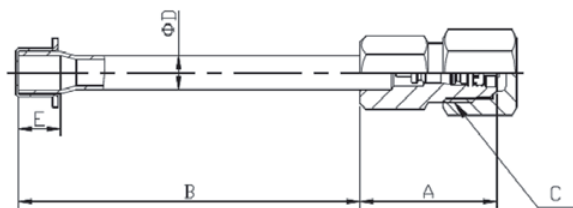

Product Series	Refrigerant	A	B	C	D	E	Model
		[mm]	[mm]	[inch]	[inch]	[mm]	
TCJ 2	HCFC	26	65	7/16-20UNF	1/4	8	TCJ-2HMSZ-1
TCJ 2	HFC	26	65	1/2-20UNF	1/4	8	TCJ-2GMS-1

TCJ SERIES
Charge Valve

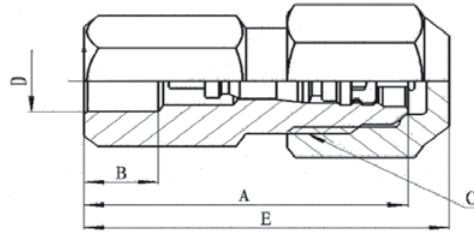
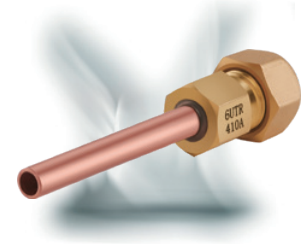

Product Series	Refrigerant	A	B	C	D	E	Model
		[mm]	[mm]	[inch]	[inch]	[mm]	
TCJ 2	HCFC	26	6	7/16-20UNF	1/4	29.5	TCJ-2HLEN-1
TCJ 2	HFC	26	6	1/2-20UNF	1/4	29.5	TCJ-2GLEN-2

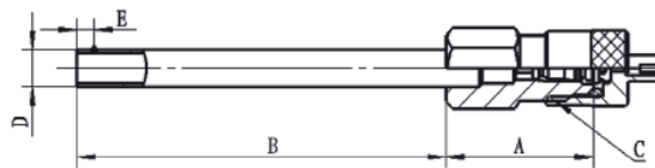

Product Series	Refrigerant	A	B	C	D	E	Model
		[mm]	[mm]	[inch]	[inch]	[mm]	
TCJ 2	HCFC	26	65	7/16-20UNF	1/4	3	TCJ-2HWT-2
TCJ 2	HFC	26	65	7/16-20UNF	1/4	3	TCJ-2GWT-4