

LRA-A/B/C SERIES

Liquid Receiver

Liquid receiver are usually installed on high pressure liquid line of refrigeration systems to store excessive refrigerant when the load of the system changes.



FEATURES

- THE INLET USE SOLDER CONNECTION AND 3 TYPES OUTLET ARE AVAILABLE: A SERIES WITH SOLDER CONNECTION, B SERIES WITH FLARE CONNECTION, AND C SERIES WITH ANGLE VALVE STRUCTURE
- INTERNAL FLOW-OUT IS REALIZED BY SUCTION TUBE
- POWDER COATED SURFACE CAN SURVIVE 500 HOURS OF SALT SPRAY TEST

GENERAL SPECIFICATIONS

- Applicable refrigerant: HCFC, HFC and HFO
- Applicable medium temperature: -30°C+120°C (-22°F~+248°F)
- Applicable ambient temperature: -30°C+55°C (-22°F~+131°F)
- Maximum working pressure: 3.5MPa (500psig)
- Certification: UL&CUL, PED

LRA-A/B/C SERIES

Liquid Receiver



TECHNICAL PARAMETERS

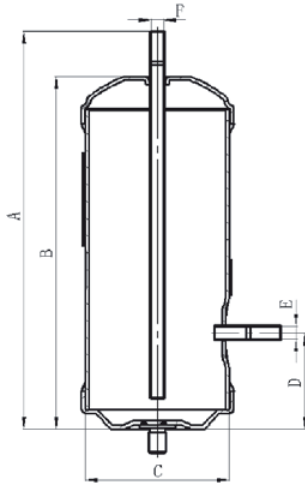

A Series

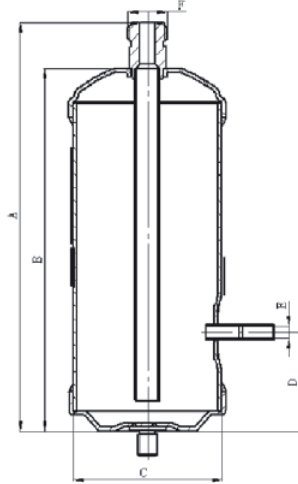

B Series

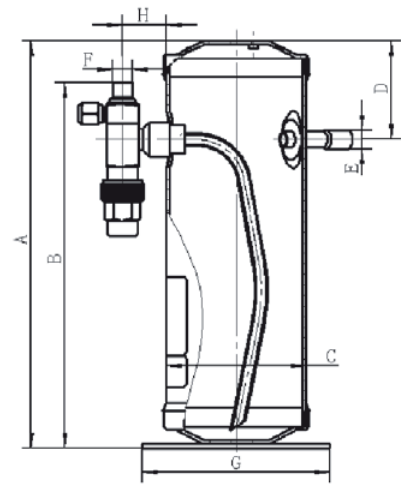

C Series

Series	Model	Internal Volume (L)	Dimensions							
			A [mm]	B [mm]	C [mm]	D [mm]	E(Inlet) [Inch]	F(Outlet) [Inch]	G [mm]	H [mm]
A	LRA-A01063-901	0.4	171	143	Φ63.5	51	1/4	1/4	/	/
	LRA-A02076-901	0.75	210	186	Φ76	51	1/4	1/4	/	/
B	LRA-B02076-901	0.75	210	186	Φ76	51	1/4	3/4-16UNF-2A	/	/
	LRA-B05127-901	2.1	221	197	Φ127	63.5	1/4	3/4-16UNF-2A	/	/
C	LRA-C01089-901	1.5	254	224	Φ89	63.5	3/8	3/8	120	28
	LRA-C02127-901	2.5	257	240	Φ127	63.5	3/8	3/8	165	28